

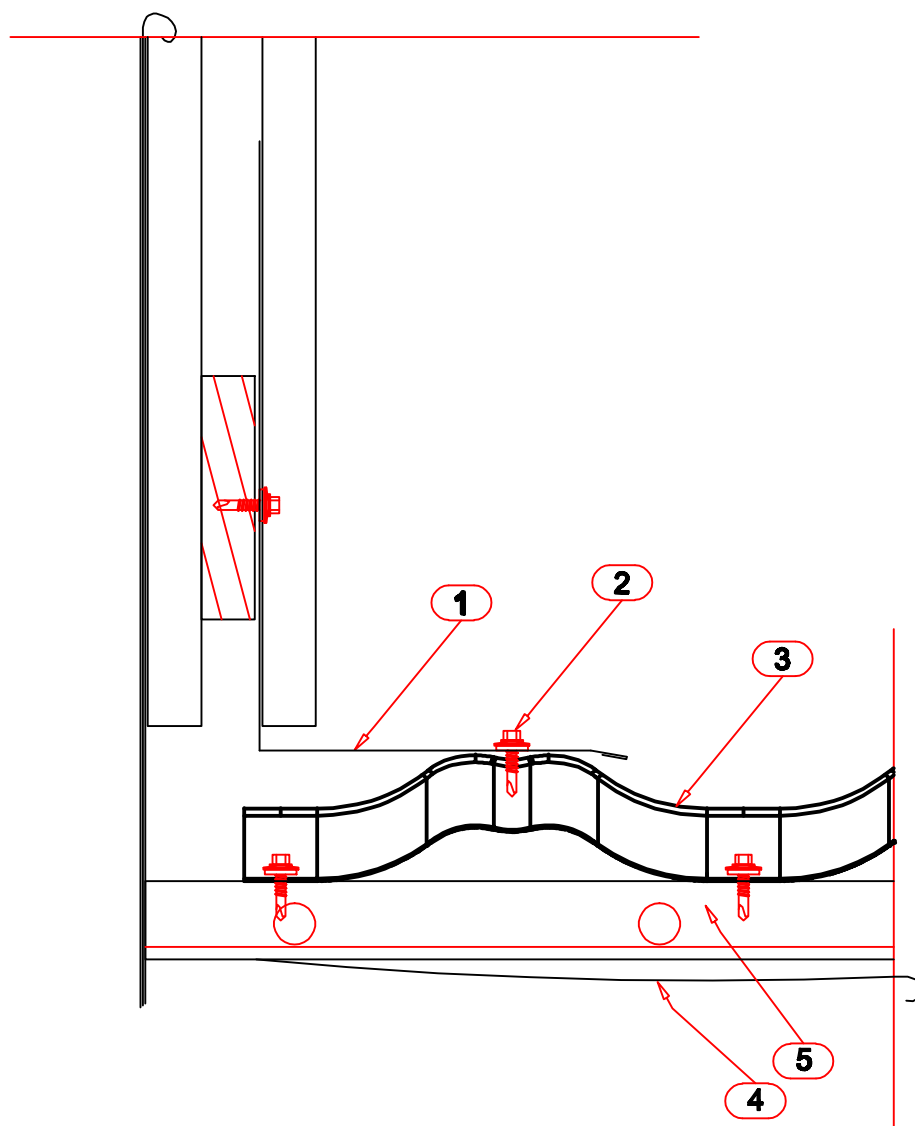

Contents of drawing

Ruukki Finnera
Steel battens
Side wall

Date 23.07.2009	Rev. date .	Work nr. .	Drw. nr. .	Rev. .
Drawn by Ruukki	Rev. .			
Scale 1:3	Building .	File nr. .		



1. JOINT FLASHING, RA1BJ
2. FASTENER, as in installation manual
3. FINNERA
4. ROOFING UNDERLAY
5. STEEL BATTENS, RA545 3700